

The Congressional Club Museum and Foundation

GALLERY GUIDE



Watercolor by Second Lady Karen Pence, Club Member

2001 New Hampshire Ave, NW
Washington, DC 20009
Phone: (202) 332-1155
Club@thecongressionalclub.com
www.thecongressionalclub.com

 @Founded1908
  @Congressionalclub

The Historic Clubhouse

The landmarked Congressional Club building, designed by Ecole des Beaux Art-trained architect George Oakley Totten, Jr. and constructed in 1914, exemplifies the vision of Mary Foote Henderson. Henderson was the wife of Senator John Henderson of Missouri, an early Club member and pioneering development advocate for the beautification of 16th Street. As a student, resident of the street, and a strong believer in the City Beautiful Movement, Mary Henderson sought to transform 16th Street into a premier gateway to the Nation's capital with the same grandeur as the capital cities of Europe. Through her social connections, passionate public petitions, written testimonial, Congressional appearances and deep-pocketed speculative development, Mary Henderson promoted the idea of developing 16th Street into the "model street of the country, one of the greatest of national boulevards." While the United States was projecting an image as a world leader, Mary Henderson promoted the idea that 16th Street could be an international showpiece of the finest in American architecture and landscape architecture.



Mary Foote Henderson

By 1914, The Congressional Club had outgrown its building at 1432 K Street, NW and formed a committee to search for an alternative space. Mary Henderson seized an opportunity to provide the Club with a new building as a way of furthering personal efforts to develop 16th Street into a grand avenue. To that end, Henderson offered the Club the services of her preferred architect, George Oakley Totten, Jr. who designed the clubhouse building on a lot of land chosen by Henderson at the intersection of 16th Street and New Hampshire Avenue, NW. For the triangular-shaped site, Totten designed a classically detailed, wedge-shaped building with a dome-cover rotunda at the apex. The building is constructed of buff brick with limestone trim and is set upon a rusticated base supported by smooth brick wall surfaces above. The U Street and New Hampshire Avenue elevations feature large, tri-partite "Palladian" windows on-center of the main part of the house.

The new clubhouse building site, below Meridian Hill at the upper end of 16th Street, for The Congressional Club was a critical link in Mary Henderson's goal of a boulevard of national significance from The White House to beyond the city's original boundary at Florida Avenue. The Club's direct association with Members of Congress, the President's

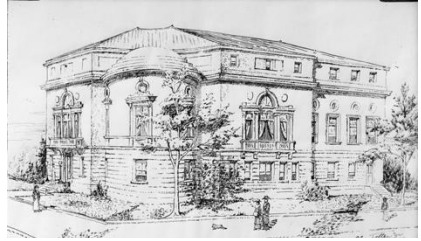

Architect's original rendering of the Congressional Club building.

Cabinet and the Supreme Court would bring great prestige and cachet to the avenue and help catapult Henderson's vision beyond her own personally financed development projects into a broader, yet socially elite sphere of influence. The Clubhouse was completed in November of 1914 and opened with a small reception at which President Wilson was the guest of honor.

The Congressional Club

Chartered by Congress in 1908 as a social club for the spouses and daughters of Members of Congress, the original purpose of The Congressional Club was to provide a non-partisan setting for fostering friendship where politics were checked at the door. Mary Breck Perkins of New York was the first Club President.

The scope of the Club and breadth of activities has broadened over the years. Membership now includes spouses of the President's Cabinet and U.S. Supreme Court; and the Club's primary focus has shifted to serving the Washington, DC community with not-for-profit partners like Martha's Table and the DC Dream Center. The Club supports causes across the country with a particular focus on charitable organizations that help members of the military and their families.

The Collection

For over a century, the Congressional Club has received many valuable gifts from American leaders, artists, designers and foreign dignitaries. Spouses of Members of Congress and the President's Cabinet have personally donated furniture, silver, rugs, china and art objects over the years to decorate the clubhouse, creating a unique collection of Americana and decorative arts spanning the 20th century.

MUSEUM GALLERY MAP

First Floor

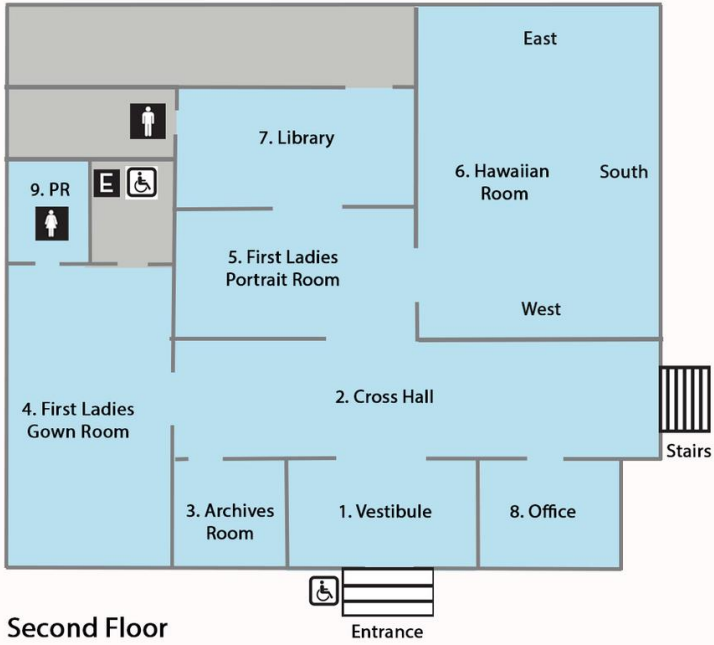

Second Floor

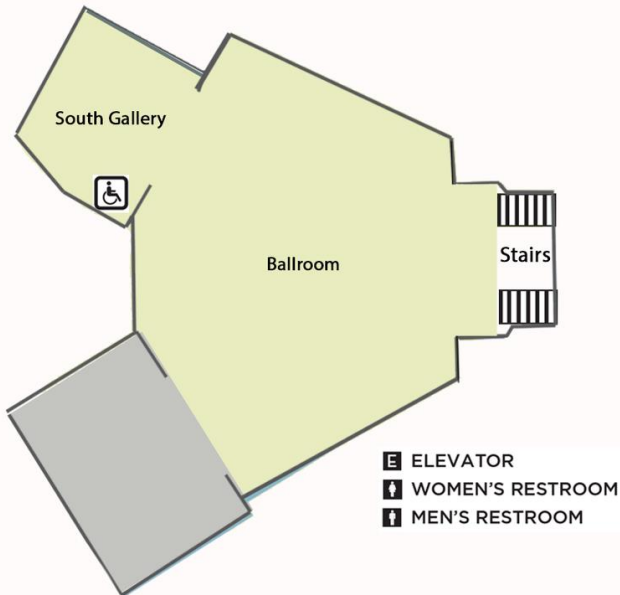

FIRST FLOOR

1. Vestibule

Lit by a crystal chandelier, the vestibule sets the grand tone for the rest of the house. Four framed 1987 Hutchins paintings of the Supreme Court, Congressional Clubhouse, Capitol and White House decorate the south wall; on the north wall, an antique Baccarat crystal bowl on a gilt-chased bronze base, sits up on a card table with lyre base.



Rococo-style ormolu candelabra.
Gift of Mrs. Russell V. Mack



Baccarat crystal bowl,
on gilt-chased bronze base.



American Chippendale Revival
Eagle Crested Mirror



Duncan Phyfe-style lyre pedestal card
table. Mahogany. Reproduction.

2. Cross Hall



Lit by a baccarat-style chandelier, the cross hall features paintings by prominent American artists Lucien Whiting Powell and Joseph Megers; and Italian artist, A.J. Virano. Also on display are items from the museum's fine porcelain and furniture collection.



"Venice." Lucien Whiting Powell.
American. 19th century. Gift of
Mary Foote Henderson.



American Southwest Land-
scape. Lucien Whiting Powell.
American. 19th century. Gift of
Mary Foote Henderson.

Lucien Whiting Powell (1846–1930) was a renowned landscape painter. He accompanied a geological survey party to the Grand Canyon of the Yellowstone Park in 1901 and visited Italy in 1910. Powell was patronized by Mary Henderson and her husband, a Senator from Missouri, who established a studio for him in their "castle." Mrs. Henderson grew very fond of Mr. Powell's artistic talent and owned over 70 of his paintings, which included these two remarkable paintings gifted to the Club. Some of Powell's favorite scenes to paint were: Venice, Rock Creek Park in Washington, DC, and scenes around Northern Virginia, the Grand Canyon, the Holy Land, and Egypt.



"Swamp." Joseph Meeker.
American. Gift of Mary Foote
Henderson.

Joseph Meeker a renowned painter of southern landscapes, was born in Newark, NJ and grew up in Auburn, NY. He received a scholarship to the National Academy of Design in New York City, where he studied with the Hudson River School painter Asher B. Durand and with portraitist Charles Loring Elliott. In 1949, he established a studio in Buffalo, NY. In 1952, he moved to Louisville, KY, before settling permanently in St. Louis, Missouri, where he painted the Louisiana Bayou in 1959.



"Venice." A.J. Virano. Italian. 19th century.
Gift of Mary Foote Henderson.



Breakfront Cabinet. Mahogany breakfront cabinet, a reproduction of 1790 American cabinet, houses unique porcelain pieces in the collection.



Hutschenreuther Porcelain Eagle. Carolus Magnus Hutschenreuther (1794-1845) established the first privately owned porcelain factory in Northern Bavaria, Germany in 1814.

A similar eagle was formerly in The Family Residence, the White House, Washington D.C. in the 1970's



Bird of Peace Plate. Boehm Studio, NJ. Gift of Mr. and Mrs. Edward Boehm.



Robin Figurine. This figurine was originally a gift to First Lady Nancy Reagan from the Boehm's in 1985 on behalf of the Congressional Club. Boehm Studio, NJ.



Ruby-throated hummingbird. Porcelain. Boehm Studio, NJ. Gift of Mr. and Mrs. Helen Boehm. 1985.



“Robin with Daffodils” photo. This Boehm bird figurine was presented to Queen Elizabeth II by The Congressional Club in 1964. Pictured next to the robin is a framed letter of appreciation from Buckingham Palace.



Tea Set. This blue and raised gold etched design tea set was decorated by the White's Art Company of Chicago. The set is prominently marked on the reverse with the red triangle stamp used by White's Art Company between 1914 – 1923. Presented to the Congressional Club by James Jenkins, Arlington, VA on behalf of the Pickard Collector's Club, Ltd.



Rose Canton Chinese bowl. 18th century. Gift of Mrs. Arthur Vandenberg, Michigan. 1952.

(Cross Hall collection continued – Opposite Breakfront)



Rococo Gilt Bronze Commode. Ormolu trim with marble top.

French, 19th century. Gift of Mrs. Russell V. Mack.

3. Archives Room



Table. Paneled top, checker inlaid edge and skirt, tapered legs with spade feet, concaved paneled stretcher shelf, satinwood. The table once belonged to prominent American landscape painter, George Inness. American, 19th century. Gift of Mrs. Russell Mack.



Carved back pearwood chairs with pierced and carved back with flowers, taper legs. Italian, 19th century. From the estate of George Inness. Gift of Mrs. Russell Mack.

The Archives Room also serves as the photo gallery for former Congressional Club presidents.

4. First Ladies Gown Room



In 1961, Baron Langer Von Langerdorf, widely known for creating the White Shoulder perfume donated the *Evyan Collection of One hundred Years of Great Lady Fashions*. Miss Evyan of Evyan Perfumes created the original three foot dolls. Since the initial dedication, the designer of each First Lady's Inaugural gown has donated to the collection. Proudly showcased in the Gown Room are designs by James Galanos, Harvey Berin, Carolina Herrera, Oscar de la Renta, Jason Wu and Hervé Pierre. Lighting the room is an antique chandelier with ormolu trim which was originally gas-lit.



Barbara Bush
Inaugural gown



Caroline Scott Harrison
Inaugural gown



Mary Todd Lincoln
Inaugural Gown

5. Portrait Room



The Portrait Room features a 19th century crystal chandelier gifted by Mrs. Russell Mack of Washington. The room is decorated with autographed pictures of First Ladies beginning with Mrs. Florence Harding. In the display case are objects of Club history, as well as unique pieces of decorative art.

Display Case



Left Bay / Top Shelf

Doll made by 1999-2000 Congressional Club President Lois Breaux of Louisiana for the 1984 World's Fair.



Congressional Club memorabilia: Ivory club gavel (1911), President's pin (1929-30), 1988 Founder's Day pin box, and one of only two minted 14k gold presidential coin presented by the Club to Richard Nixon April 27, 1972.

Left Bay / Center Shelf



Bowl. Commemorative bowl from the 100th First Lady's Luncheon honoring First Lady Michelle Obama. Woodmere china, New Castle, PA.



Plate. White House Collection. Reproduction from the White House china patterns used during the administration of Benjamin Harrison, 23rd President of the United States (1889-1893).

Left Bay / Bottom Shelf



Vase. Delft blue and white porcelain.

Center Bay / Top Shelf



Sèvres Porcelain and Ormolu-Mounted Ewer with flowers and romantic panels on yellow background; gilt brass mounts. French. 18th century. Gift of Mrs. William McCullough, OH, 1962.



On the same shelf is a photograph of Mary Foote Henderson, a founding member and patron of the Congressional Club.

Center Bay / Bottom Shelf



Two porcelain vases. White with pierced brass trim. 19th century. Gift of Mary Foote Henderson.

Right Bay / Bottom Shelf



Chinese war lord Kuantai. China. 13th to the 16th century.

6. Hawaiian Room





English cut wall sconces. Pair. Acquisitions of the estate of Mrs. Richardson. In the Hawaiian Room are two of four sconces, the matching pair hang above the fireplace in the ballroom on the second floor.

Hawaiian Room - East



Small Display Case features items commemorating The Congressional Club's Red Cross Service during World War II: Certificate of Appreciation, service pins, and photos of Congressional Club members working

together in the second floor ballroom. Since World War I, and through the end of WWII members met from ten in the morning until four o'clock in the afternoon one day each week to make surgical dressings. During the war, a Bond Booth was staffed by congressional spouses at one of the large hotels in DC and one afternoon each week a majority of members could be found at the Troops-in-Transit Lounge in Union Station.



Hanging on the East wall are five original architectural blueprints of the clubhouse by George Oakley Totten, Jr. 1914.

Large display case features historical highlights of The Congressional Club's history, the nation's capital and famous speakers entertained as guests of the Club.



Original photo of the first Clubhouse at 1432 K Street, NW. President and Mrs. Taft attended the house warming.



Signed portrait of Mary Foote Henderson, and photo of Henderson's home on 16th Street, referred to as "Henderson's Castle."



Photo of early members of the Congressional Club proudly posing outside their new clubhouse. Front row (left to right): Mrs. Fred Dennett (ND), Mrs. Lemuel Padgett (TN), Mrs. James T. Lloyd (MO), Mrs. Duncan Fletcher (FL), and Mrs. Zouner (guest). Back row (left to right): Mrs. Thomas Gore (OK), Mrs. Henry Allen Cooper (WI), Mrs. John Rankin (MS), and Mrs. Frank Briggs (ME).

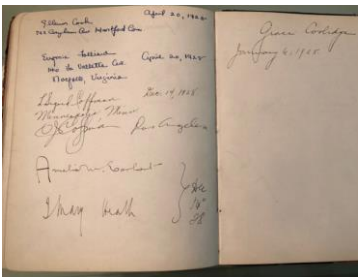

1928 Congressional Club guestbook showing Amelia Earhart and Great Britain's famed female aviator, Lady Mary Heath's signatures when they visited the Club on December 14, 1928. Both were in town for the International Civil Aeronautical Conference that year.



Guestbook open to the page with signature of Congressional Club guest, astronaut Anna Lee Fisher. Anna Fisher was the first mother in space, Fisher flew on the 14th flight of NASA's Space Shuttle program, and the second flight of Space Shuttle Discovery. The mission launched from Kennedy Space Center on November 8, 1984 and landed on November 16, 1984.



Trowel used for the laying of a dedication stone for the National Cathedral [2 photos of the cathedral under construction, certificate of appreciation from the Bishop of Washington].



Silver bowl used for the burning of the Congressional Club's mortgage in 1948, photo of the burning ceremony, and original manuscript of the Congressional Club song sung at the mortgage burning.



Congressional Club Cookbook. Sixth edition published in 1961 with a forward by First Lady Jacqueline Kennedy.



Right of the large display case is a video of **Annie Laurie Rankin Sanders** (1923-2017) providing an oral history of The Congressional Club and anecdotes of life in Washington, DC. Rankin joined as associate member in 1944 and personally knew Club founder Mary Perkins of NY. 



H.R. 22029 A Bill to Charter The Congressional Club. On the wall to the right of the large display case is a framed copy of the 1908 Congressional Act establishing the Congressional Club.

Cookbook History

The Club has been self-supporting since the day of its organization, and contrary to supposition, it has never received a grant or any support from the Federal government. First published in 1927, sales of The Congressional Club Cookbook have supported the Club and is a tradition that chronicles American history with early editions featuring recipes from the eras of Prohibition, the Great Depression and World War II meals on rations. Timeless and delicious recipes like First Lady Martha Washington's macaroni and cheese and Jacqueline Kennedy's fish soup (pictured in the display case) showcase unique family traditions of the Nation's leaders and their spouses. Each beautiful cookbook is a symbol of the collection of friendships cherished by its members.

To Purchase a Cookbook Stop by the Office or Shop Online
www.theCongressionalClub.com/Shop

Hawaiian Room - West

Nine original prints by artist and printmaker. 18th century. Gift of former Congresswoman Elizabeth Farrington, HI.



John Webber (1752-1793) was an English expedition artist noted for his images of early Alaska and Hawaii, which he created while serving as official artist on Captain James Cook's exploration of the Northwest and the Pacific. On this voyage where Cook lost his life in a fight in Hawaii, Webber became the first European artist to contact Hawaii, then called the Sandwich Islands. He did numerous watercolor landscape sketches of Kauai and the Big Island of Hawaii to depict Hawaiian people and their activities.

Needlepoint Crest. The American Needlepoint Guild, Inc (ANG) completed the project over 16 months and gifted the needlepoint in 1994 at the First Lady's Luncheon honoring Hillary Clinton.



An object of ANG is to preserve and create embroideries for historic U.S. landmarks. First Lady Barbara Bush was a Congressional Club Member and ANG Member. When Congresswoman Doris Matsui was Club President, the partnership with ANG began.

7. Library



The Library features rare books, first editions, and those signed by prominent authors who visited The Congressional Club over the years.



Bookends. These bookends were made from the marble taken from the White House when it was rebuilt during the Truman administration.

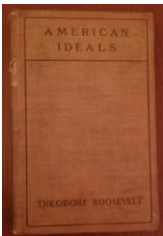

One of the rare books in the collection is a first edition of President Theodore Roosevelt's essay, *American Ideals*.



The New Freedom was Woodrow Wilson's campaign platform in the 1912 presidential election. Wilson later wrote this 1913 book of the same name.



Among the many rare books in the collection are these Old Chinese Books. In the summer of 1920, a group of congressmen toured the Orient. While in China, the Commercial Press of Shanghai, as a gesture of good will, presented the delegation with a set of rare old Chinese books. Since these were gifts of inestimable value, the Congressmen asked the Congressional Club to be their permanent custodians. The collection was donated formally on February 25, 1921 with the Chinese Minister as the guest of honor.



American Eagle banjo clock. American wall clock with a banjo-shaped case. It was invented by Simon Willard, originally of Grafton, MA, later of Roxbury, MA, and patented in 1802. The banjo clock normally lacks a striking mechanism and indicates time only by its hands and dial. American. 19th-century.



American Bald Eagle Plate, Boehm Plate, England, Bicentennial Plate. There are also four of these plates over the fireplace in the Portrait Room.



A pair of urns featuring portraits of George and Martha Washington. French Enamel on porcelain, France, c. 1820-1840. French porcelain of this era is generally known as “old Paris” or “vieux Paris” and was made in a broad

variety of forms, both decorative and functional. The production of French porcelain for the American market was extremely limited in the early 19th century, primarily restricted to bespoke orders from wealthy American families and important figures because of remote access and high cost. U.S. Presidents Adams, Madison and Monroe all selected French porcelain dinner services for their residency in The White House and these examples are highly sought after today.



Pair of Dresden porcelain vases.

Dresden Porcelain is from a porcelain factory in Freital near Dresden, Germany. Founded in 1872, the factory still keeps alive the long tradition of European porcelain art. Gift of Mrs. Russell Mack.



Pair of Chinese pattern plates. 19th century.

8. Office

The Executive Director's office highlights special items from the collection.



Small crystal lamp. Gift of Mrs. Woodrow Wilson in 1933.

9. Powder Room

The first bride married in the Congressional Club was Erma Strong Haworth, on February 12, 1923. Her gown is displayed in the ladies' powder room. A one-inch band of lace around the waist came from a dress her mother wore to President Abraham Lincoln's Inaugural Ball in March 1861.



GRAND STAIRCASE



SECOND FLOOR



The stairwell leading to the ballroom features a large Waterford chandelier, originally gas lit.



At the entrance to the ballroom are two Boehm American eagles. White bisque porcelain. Gift of Edward and Helen Boehm.

10. Ballroom



The ballroom is the heart of the clubhouse, where most activities are held.



An antique Steinway concert grand piano has been a focal point of entertaining in the clubhouse since its beginning.

11. South Gallery

The South Gallery functions as temporary exhibit space featuring furniture and decorative arts from the collection.



Currently on display in the gallery are a pair of Philippine hand-carved tables. Philippine Narra hardwood. Gift of General and Mrs. Carlos Romulo, Delegate to Congress from the Philippines.



With Appreciation

The Congressional Club Museum and Foundation thanks the Executive Board Members, Beth Harvey, Stephen Hansen Principal of Preservation Matters LLC, April McClain-Delaney, Richard Newman and the law offices of Arent Fox, LLP for their enormous efforts to present this gallery guide.

We Invite You to Share Your Experience Using
#CongressionalClub

Visit Us Online
www.theCongressionalClub.com

And Connect With Us

 @Founded1908
  @Congressionalclub